

2015

An Interactive Neilson

Cara Dietz
Smith College

Alyssa Graveline
Smith College

Renee Klann
Smith College

Follow this and additional works at: https://scholarworks.smith.edu/scl_neilson



Part of the [Interior Architecture Commons](#)

Recommended Citation

Cara Dietz, Alyssa Graveline, and Renee Klann. "An Interactive Neilson." Smith College Scholarworks.
http://scholarworks.smith.edu/scl_neilson/

This Article has been accepted for inclusion in The New Neilson Library by an authorized administrator of Smith ScholarWorks. For more information, please contact elanzi@smith.edu.

An Interactive Neilson

locating, learning, and communicating like never before

Cara Dietz, Alyssa Graveline & Renee Klann

student and faculty commentary

Students currently have trouble finding resources in Neilson library.

“How shall I ever find the grains of truth embedded in all this mass of paper? I asked myself”
-Virginia Woolf, *A Room of One's Own*

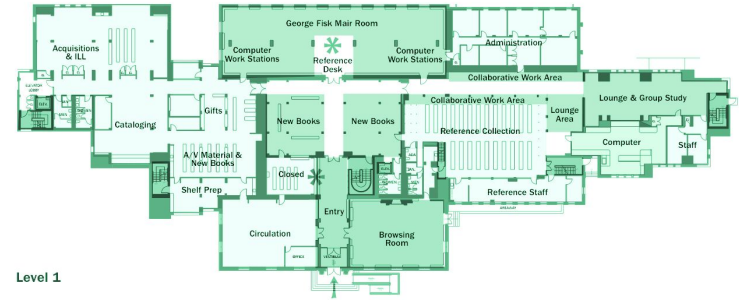

Students requested:

- “someplace where I can navigate the stacks easily and find what I am looking for quickly”
- a “better and more easily navigable layout”
- “legible maps so we can actually navigate the library”

student and faculty commentary

“Being able to browse or peruse are intrinsic in a library experience, no matter the century.”

“We still need physical books . . . but with new ways to access them.”

One person requested a library that, “while allowing new innovative technology to be utilized by members of the community, also keeps its roots in traditional library services (i.e. physical copies of books, in stacks, that are available for people to browse.)”

What Neilson Library needs is a smart browsing system that enables people to locate books and see each book's ratings, comments, and recommendations.

This system will reduce barriers to finding books and checking them out, so Neilson Library's print resources will be more accessible and used more frequently.

The new system will also allow students and faculty to help each other in the search for information, enhancing the intellectual community of Smith College.

our proposal:
create an
app

The app will include a navigation system to show where books are and guide readers to them. It will also feature a system for readers to comment on books and recommend them to others.



the technology

RFID + Livescribe

RFID: Radio Frequency Identification

RFID can be used to track where books are and show readers how to find them.

The Smartstock™ 600 system can be integrated into existing shelving, and it continuously records the location of books. This data can be inserted into the app, to display a floorplan that pinpoints the location of a book that a reader is trying to find. The units can also light up to make locating books even easier.



Livescribe





The comment and recommendation system is inspired by “kites,” which are notes tucked between the pages of books in a prison library by inmates trying to secretly communicate with each other.

Neilson Library’s kiting system will be based on Livescribe technology. When readers want to comment on a book, they can write with Livescribe pen and paper. The pen will instantly upload whatever is written to the library app, so the comments can exist in both paper and digital forms. This will ensure that comments and recommendations are accessible to all library users.

Potential Kiting Technologies - the pros and cons

Anoto

Pros:

- ❖ paper printable in library
- ❖ instant/direct upload

Cons:

- ❖ must purchase pens
- ❖ compatible surface needed - can't access outside library

Evernote

Pros:

- ❖ app accessible outside library
- ❖ can use any medium

Cons:

- ❖ must purchase paper
- ❖ must manually upload

Livescribe

Pros:

- ❖ app accessible outside library
- ❖ instant/direct upload

Cons:

- ❖ must purchase paper and pens
- ❖ More costly

additional functions of the app



ratings

Ratings will be out of five stars, providing a condensed view of how good a book is.



comments

The comments section will give readers useful information and a chance to discuss books.



recommendations

Recommendations could be individually filtered to sort based on subject, genre, type of research project, or a reader's own past habits.

Recommendation philosophy

Recommendation algorithms like those used by Amazon, Netflix, and Pandora are well-known. However, for book recommendations to be effective, they should be more specialized and more human-generated. One example of a book suggestion system currently in use is the New York Public Library's *Bookish Recommends*, which has entries written by real people, based on shared traits of books' content and style. Readers at Smith should also have the ability to filter recommendations to fit the type of research they are doing.

Implementation

- purchase RFID system and Livescribe paper and pens
- create the app
- teach students and faculty how to use the technology

Once this is done little upkeep will be necessary.

conclusion:

This smart browsing app will be worthwhile because it will reduce barriers to finding books, and it will allow students and faculty to interact with each other through books.

